



TANGER MED II – Tanger Alliance

OPEN FOR BUSINESS



TANGER MED - WORLD CLASS HUB PORT



TAT Shareholders



**M★RSA
MAROC**

50% + 1 action



40% - 1 action



Hapag-Lloyd

10%



TAT ...HISTORY



PROJECT PHASE

OPERATIONS START UP



TAT IN NUMBERS

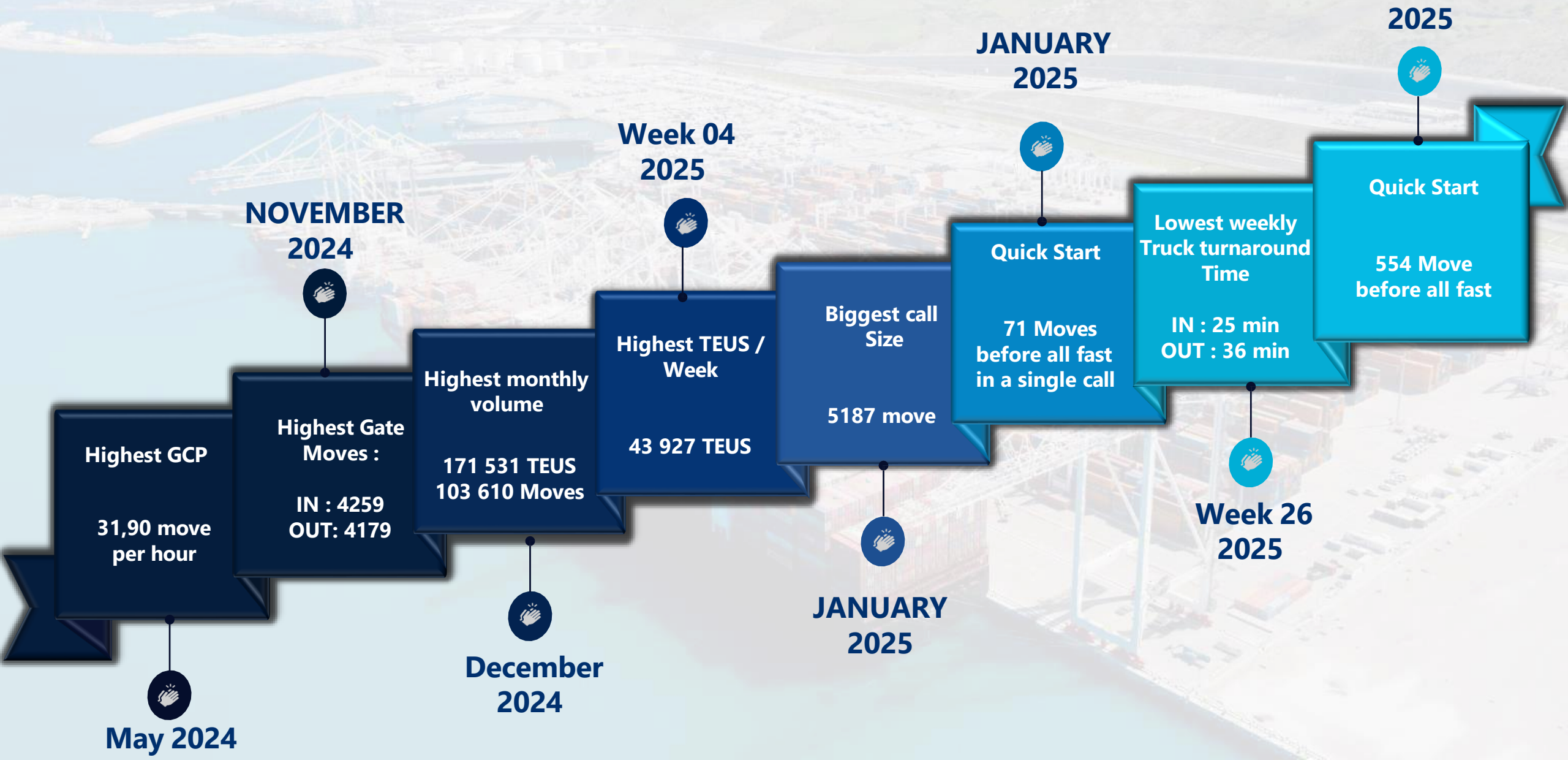

BLUEPRINT OF TANGER MED II PORT

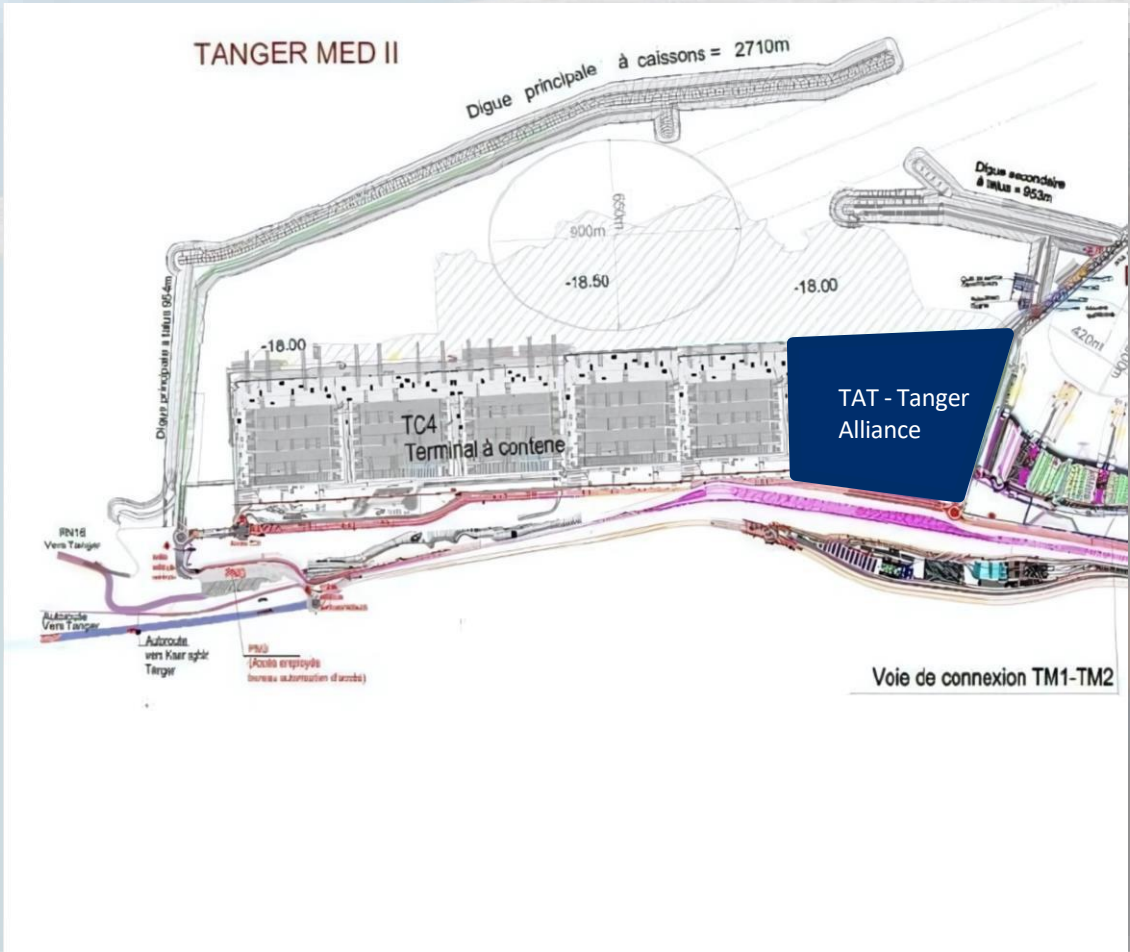

TAT TECHNICAL DETAILS

Item	Description
Quay	800m
Terminal area	36ha
Number of Quay Cranes (STS)	8 STS (x25 rows on a Vessel)
Designed Capacity	1.600.000 TEUs
Depth	-18m
Start of Operation	1 st January 2021
Reefer Plug	1.540 (nominal capacity)
DG Capacity	675 TEUs (nominal capacity) with a possible increase of 10% depending on non-DG container density
DG Restrictions	<ul style="list-style-type: none">Transhipment is not permitted for Class 1, 6.2 and 7, only in-transit (remain on board) and direct Import/ExportQuantity limitations of 2.000 tons (with max of 200 tons per block with min. separation of 25m) applies to UN number:<ul style="list-style-type: none">- Class 5.1: UN1942, 2067, 2426, 3375- Class 9: 2071
OLD Gates	3 Gate-OUT and 3 Gate-IN (flexible on demand)
NEW Gates	2 Gate-OUT and 2 Gate-IN (flexible on demand)

TERMINAL EQUIPEMENT



BERTHS

ACTUAL QUAY	800 m	WATER DEPTHS	17.4m
		TERMINAL AREA	360,000 m2

YARD

ACTUAL YARD	40,000 sqm	REEFER CAPACITY: 1,540 plugs + Possibility for extra 240 plugs
		HANDLING CAPACITY 1,500,000 TEUS

RUBBER TIRED GANTRY

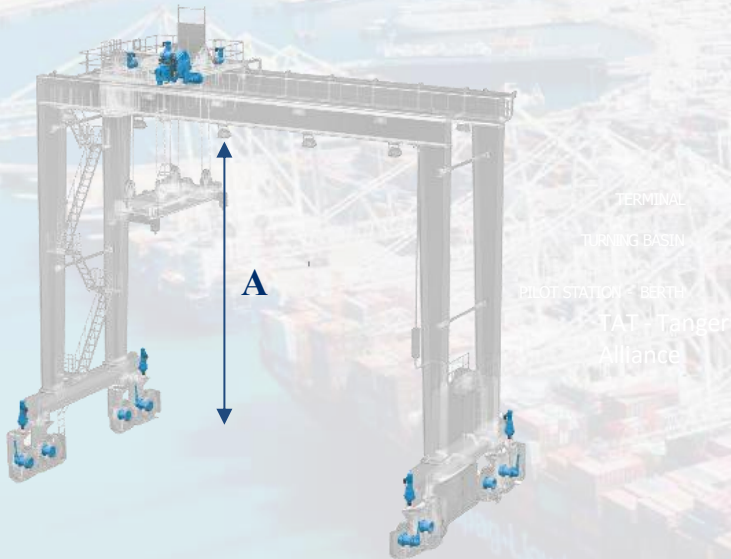

QUAY CRANE

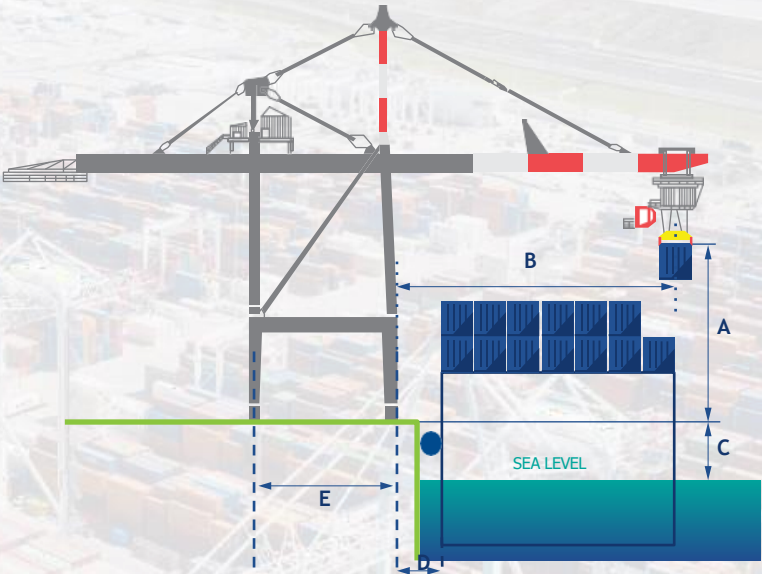

QUAY CRANES TECHNICAL DETAILS :

			A	B	C	D	E							
GANTRY CRANE COUNT	MANUFACTURER	YEAR BUILT	MAX SPREADER HEIGHT ABOVE RAIL (m)	MAX OUTREACH FROM RAIL (m)	HEIGHT RAILS ABOVE SEA LEVEL AT MAX HIGHTIDE (m)	DISTANCE RAIL-FENDER (m)	RAIL SPAN	MAXIMUM CONTAINER ROWS ON VESSEL	TYPICAL MAXIMUM CONTAINER TIERS ON DECK (DV 9'6") AT HIGHT WATER	MAX LIFTING CAPACITY (SPREADER ON)	MAX LIFTING CAPACITY (SPREADER OFF)	TWIN LIFT ABILITY Y/N	ABLE TO LIFT 4 CONTAINERS SIMULTANEOUSLY Y/N	ABLE TO OPERATE ON
8	LIEBHERR	2020/2021	54 m	72 m	3.5 m	5.7 m	30.48 m	25	11 x 9.6	65 t	85 t	Y	N	ALL BERTHS

RUBBER TIRED GANTRY TECHNICAL DETAILS :

					A	
RUBBER TO GANTRY COUNT	MANUFACTURER	Type	Year of manufacture	Capacity (T)	Height under the spreader	Span
22	KONECRANES	RTG 16W	2020	41	1 over 5 Containers	7 + truck lane

TERMINAL EQUIPEMENT

FORKLIFTS :

MANUFACTURER	TYPE	CAPACITY (T)	QUANTITY	YEAR OF MANUFACTURE
KONECRANES	SMV 25-1200C	25	1	2020
	SMV 32-1200C	32	1	
Doosan	D50C	5	2	2020
	B40X-7	4	1	
YALE	GDP 30 UX	3	4	2020



REACH STACKERS :

MANUFACTURER	TYPE	CAPACITY (T)	QUANTITY	YEAR OF MANUFACTURE
KONECRANES	SMV 4532 TC5	45	4	2020



RORO:

MANUFACTURER	CATEGORY	TYPE	5TH WHEEL TYPE	WHEEL DRIVE	QUANTITY	YEAR OF MANUFACTURE	CAPACITY (T)
TERBERG	RoRo Tractors	RT223	elevating 5th wheels	4x4	2	2020	120



TRUCKS:

MANUFACTURER	CATEGORY	TYPE	5TH WHEEL TYPE	WHEEL DRIVE	QUANTITY	YEAR OF MANUFACTURE	CAPACITY (T)
TERBERG	Terminal Tractors	YT222	Fixed & elevating 5th wheels	4x2	35	2020	70
TERBERG	Terminal Tractors	YT222	Fixed & elevating 5th wheels	4x2	5	2021	70



TAT GENERAL LAYOUT OVERVIEW



8 STS (85t) covering 800 meters

22 RTG covering 20 blocks



Terminal Area
36 ha

Safe Operational Capacity 31.603 TEUs

— Reefer 1.540 TEUs

— Empty 4.770 TEUs

— Dangerous Goods 675 TEUs

1.600.000 TEUS



Nominal Capacity

TAT NAVIGATION – PORT SERVICES



Pilot Station Coordinates = 35°54,6 N - 005°32,2 W



Pilotage time in TM II Container Ship traffic - **ADVANTAGE**

WIDTH OF PORT ENTRANCE	300m	HEIGHT ABOVE WATER LEVEL	4.5m
DEPTH OF PORT ENTRANCE	20m	TIDAL RANGE	0.8m
WIDTH OF PORT CHANNEL	900/650m	TUGS FLEET	4 tugs
DISTANCE PILOT STATION - BERTH	2.8 miles	NUMBER OF PILOTS (available)	3 pilots 24H/7

Vessel Length	Safe Distance / Vessel
LOA < 220m	30m
LOA > 220m	40m

TAT GATE CONNECTION (Highway & Rail)

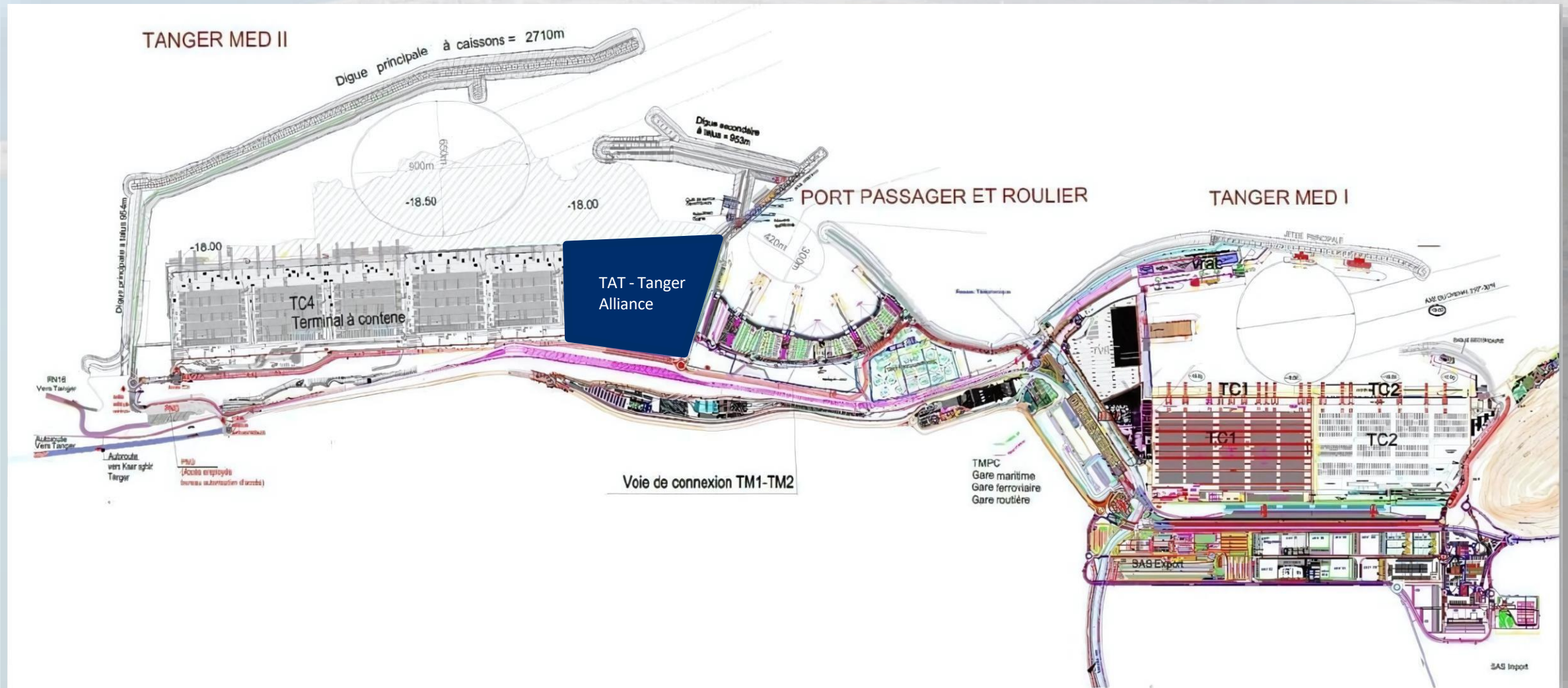

TAT CONNECTED TO THE WORLD



GLOBAL CUSTOMERS



19 SERVICES

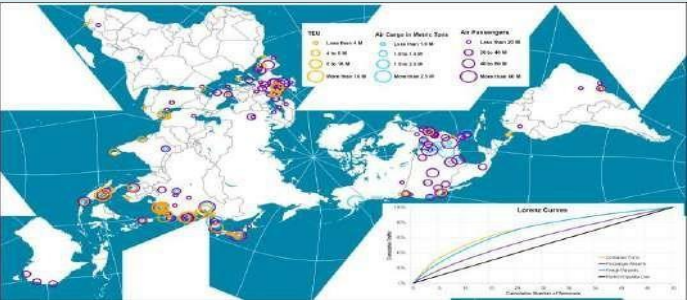

MORE THAN 110 DESTINATIONS SERVED

A crossing point on the main maritime routes, connecting the East-West and North-South of the World

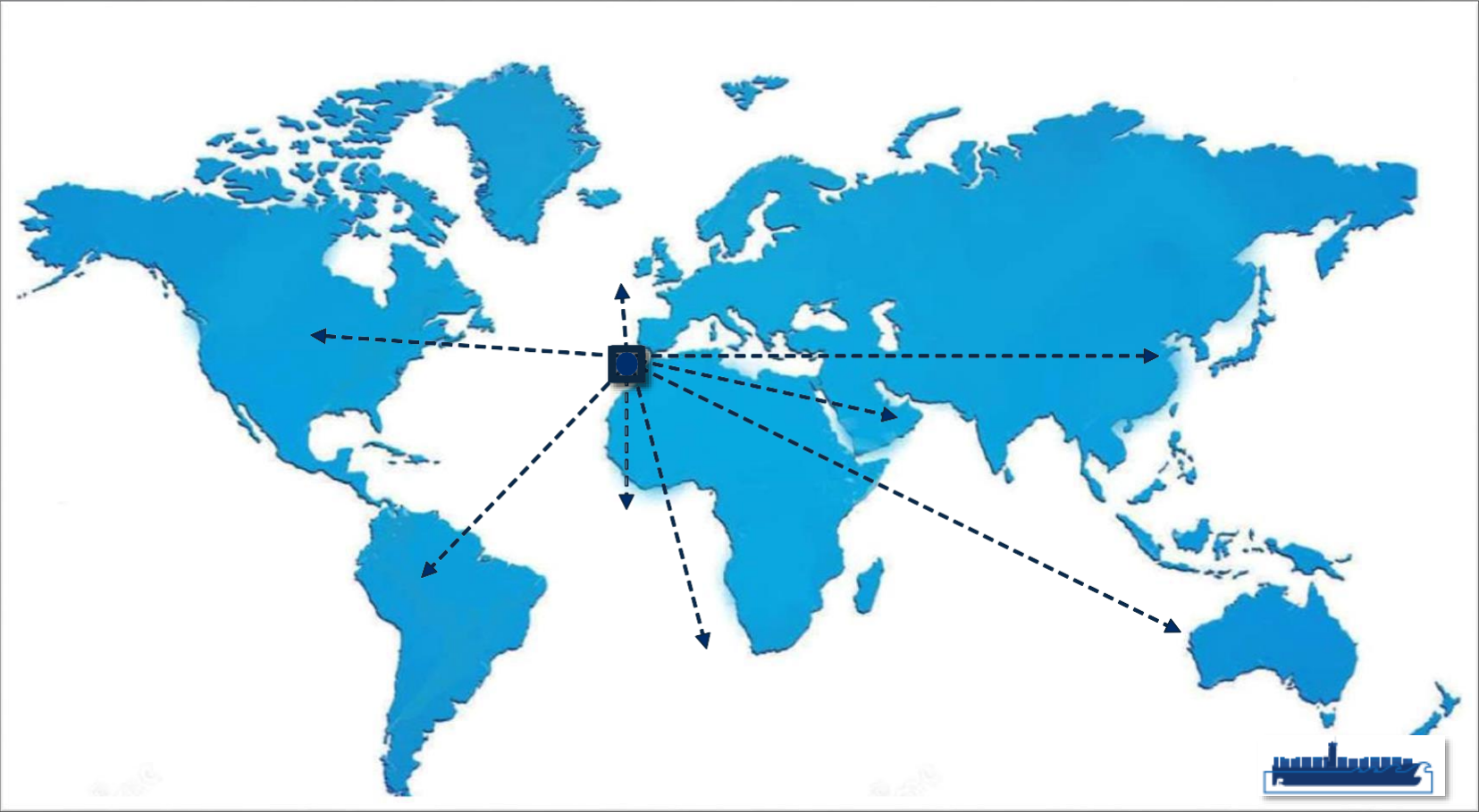

TAT THROUGHPUT 2021/2022/2023/2024 – TEUS

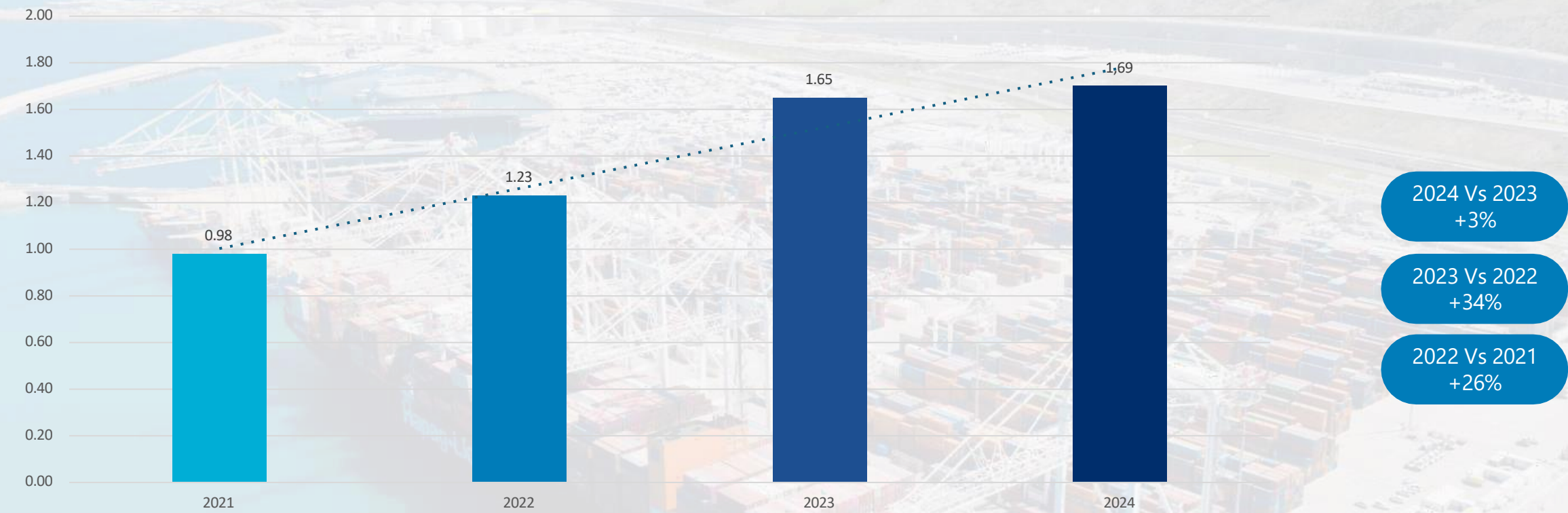

978.572 TEUs 2021
1.231.903 TEUs 2022
1,653,724 TEUs 2023
1,698,919 TEUs 2024

TAT SHIP CALLS 2021/2022/2023/2024

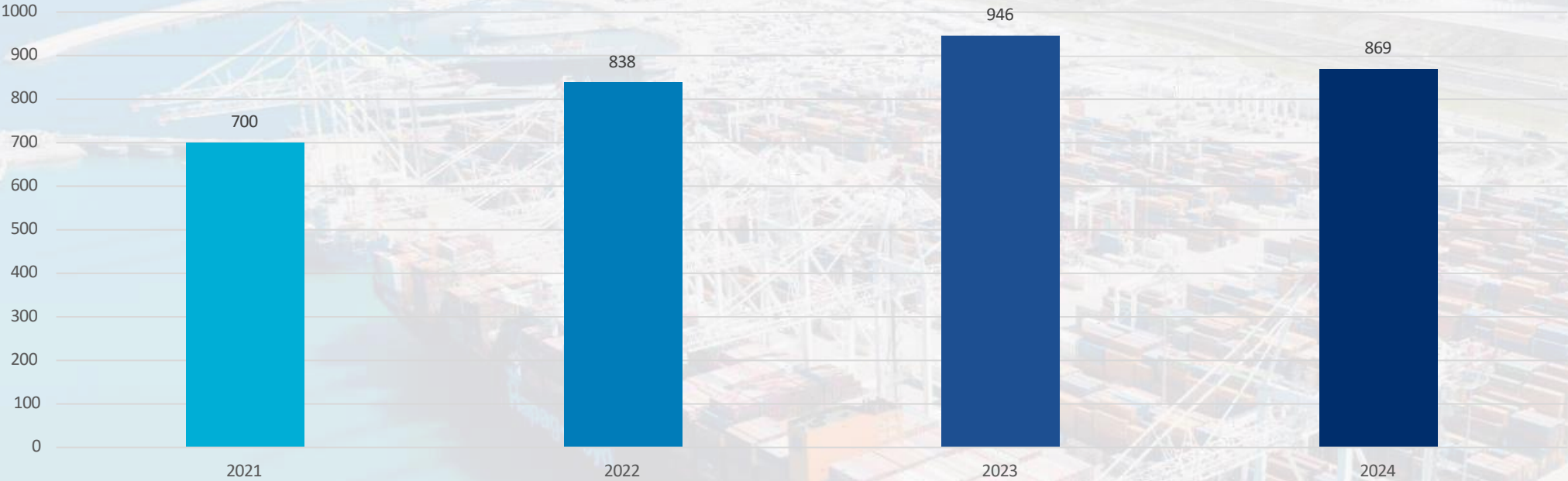

- 2024 Vs 2023
-8 %
- 2023 Vs 2022
+13%
- 2022 Vs 2021
+20%

700 Ship calls 2021
838 Ship calls 2022
946 Ship calls 2023
869 Ship calls 2024

TAT 24/7 BEST IN CLASS



TAT SHIFT HOURS

07:00 – 15:00

15:00 – 23:00

23:00 – 07:00



GATE TRUCK

Receiving and Delivery Truck from
Monday to Sunday from 07:00 to 23:00
- flexibility on demand -



TERMINAL OPERATION
365 Days/Year

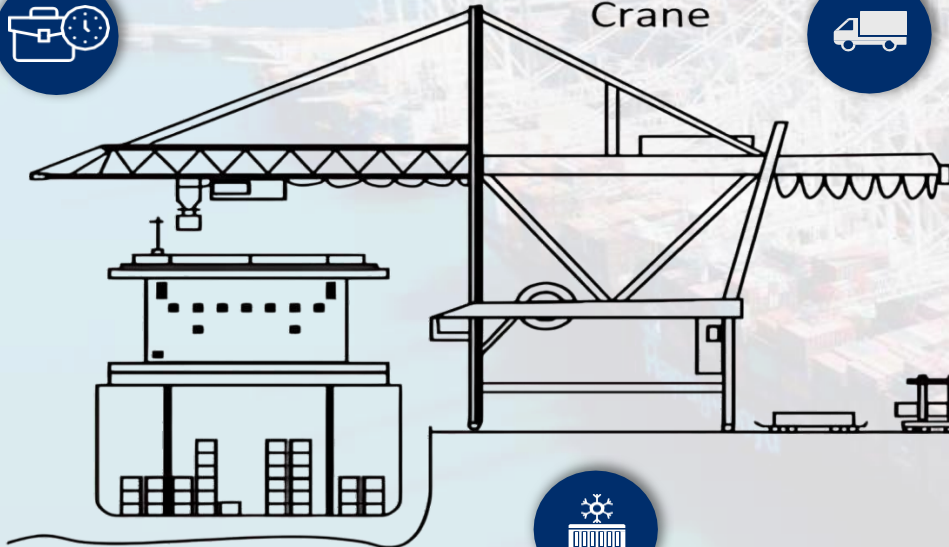

Crane

Vessel

Container
Storage

Truck / Train
Depot

**Internal Reefer Container
Pre-Trip Inspection**



ISPS compliant



Part of TM port ranked the 4th
most efficient container port in the
world (2022/2023 data, according
to CPPI by the World Bank and S&P
Global Market Intelligence)



Management Board



**President of the
Management Board**



Mr. Amine SEFRAOUI
CFO/CHRO

amine.sefraoui@tangeralliance.com

**Vice-President of the
Management Board**



Mr. Antonio CAPULA
COO/CCO

antonio.capula@tangeralliance.com

**Customer Service, Marketing
and Communication Manager**



Ms. Rajaa MORAFIK
+212 (0) 662 21 25 72

rajaa.morafik@tangeralliance.com

OUR TEAM AT YOUR DISPOSAL



THANK YOU